

s.6400 actuator mounting
hot forged 1/2"÷2"
full port brass ball valves



More and more automation is required at all levels in our society and the *k.64 RuB* range is the answer to all needs for reliable actuated ball valve. It features special seat design to automatically compensate for wear and it has successfully passed 100,000 cycle life tests. You can purchase the valve alone or with the *RuB* actuator already mounted.

Features and Specifications:

- * **Hot forged** sand blasted, unplated brass body and cap sealed with Loctite,
- * Assessment according to **Pressure Equipment Directive 97/23 CE** module B+D by Pascal (1115),
- * Finest brass according to **EN 12165** and **EN 12164** (formerly DIN 17660 and UNI 5705-65) specifications,
- * **ISO 5211** and **DIN 3337 mounting flange** for universal connection to actuator,
- * **100% full port** for maximum flow,
- * 24h 100% seal test **guaranteed**,
- * Pure **PTFE** self-lubricating seats with flexible-lip and **wear compensation** design,
- * Dual sealing system allows valve to be operated in either directions making **installation easier**,
- * Chrome plated **solid brass ball**,
- * **No metal-to-metal** moving parts,
- * Nickel plated **blowout-proof** brass stem,
- * **Two Viton O-rings** at the stem for maximum safety,
- * **No maintenance** ever required,
- * **DIN 2999, ISO 228** parallel Female by Female threads,
- * **Silicone-free** lubricant on all seals,
- * **40 bar** (Kg/cm²) non-shock cold working pressure,
- * **-20°C +170°C** temperature,
- * For use with **dangerous fluids** temperature rating is -20°C +60°C and pressure rating is 5 bar.

Options:

- * **Special valve configurations** available upon request,
- * **s.64** configuration featuring **NPT taper ANSI B.1.20.1** Female by Female threads, unplated body, reinforced seats and brass or stainless stem,
- * Rack and pinion pneumatic **actuator (spring return or double acting)**.



**ASSESSMENT
ACCORDING TO
97/23 CE
module B+D
by Pascal**

CE 1115



RUBINETTERIE UTENSILERIE BONOMI si

VIA PADANA SUPERIORE, 27/29 - FRAZ. CILIVERGHE, 25080 MAZZANO (BS) - ITALY

Fax+39 030 2629498
 Phone+39 030 212441
<http://www.rubvalves.com>
 email: sales.director@rubvalves.com

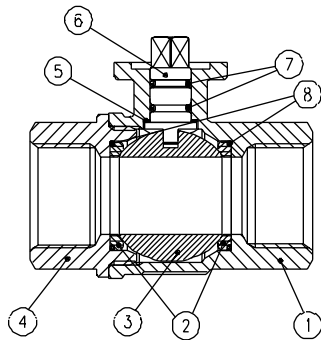

Ball valves are marked
 CE on body from
 1.1/4" to 2"
 as follow

CE Cat. III B+D
 PS: 5 GAS
 TS1: -20° C
 TS2: +60° C

1115

PART DESCRIPTION		Material	Q.ty
1	Nickel plated body	CW617N RUB001	1
2	Ball seat	Ptfe RUB008	2
3	Chrome plated ball	CW617N RUB001	1
4	Nickel plated end cap	CW617N RUB001	1
5	Washer	Ptfe carbon filled 25% RUB008	1
6	Nickel plated stem O-Ring design	CW614N RUB001	1
7	Green O-Ring	Viton RUB009	2
8	Green O-Ring	Viton RUB009	2

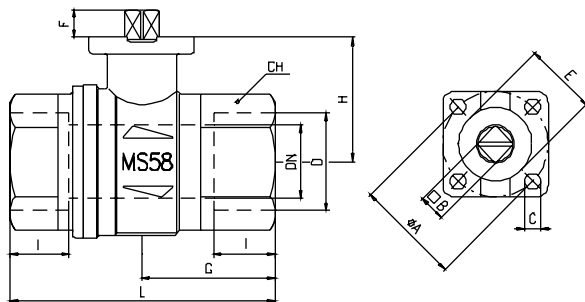

Code	S64D00	S64E00	S64F00	S64G00	S64H00	S64I00
D (inch)	1/2	3/4	1	1 1/4	1 1/2	2
DN(mm)	15	20	25	32	40	50
I (mm)	15,5	18	21	23	24,5	26,5
L (mm)	75	80	90	110	120	140
G (mm)	30,5	37	45,5	52	59	67,5
H (mm)	31	38,5	42,5	55,5	62	69
CH(mm)	27	32	41	50	55	70
øA(mm)	36	36	36	50	50	50
□B(mm)	9	9	9	11	11	11
C (mm)	5,6	5,6	5,6	6,6	6,6	6,6
E(mm)	25	25	25	35	35	35
F(mm)	7,5	8,5	8,5	10	10	10
Flange connection DN ISO 5211 DN 5337	F03	F03	F03	F05	F05	F05

Torque for Actuator Sizing – N.m

Delta P →	0 ÷ 15 Bar		40 Bar	
	Break after dwell ¹	Run torque ²	Break after dwell ¹	Run torque ²
1/2"	4	2,8	4	2,8
3/4"	5,7	3,7	5,7	3,7
1"	13,8	6,2	13,8	6,2
1.1/4"	20	7,1	20	7,1
1.1/2"	35,2	10,1	38,8	11,1
2"	48,6	13,6	61,9	17,4

Torque correction factors

Valve torque can vary according to operating frequency, temperature, and friction characteristics of the media. If media has more or less friction than water, multiply torque by the following factors.

- Lubricating oils or liquids 0.8
- Dry gases, natural gas, superheated steam 1.5
- Slurries or liquids bearing abrasive particles 1.5÷2.5

For other conditions please inquire of your RuB representative or distributor.

- 1) Torque necessary to start the stem turning after it has dwelt in one position for more than three days.
- 2) Torque needed after the break to complete the stroke. It is also the torque for immediate subsequent operations.

Pressure - Temperature chart

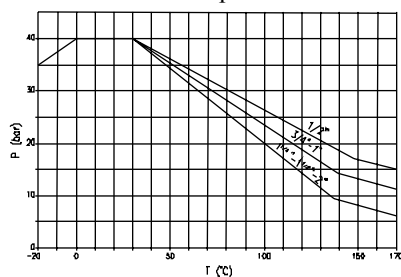

PRESSURE DROP CHART

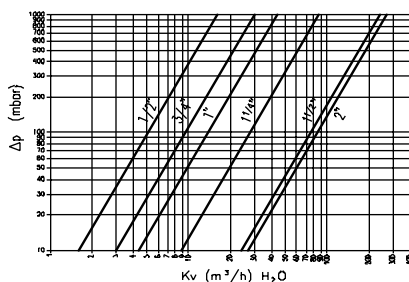

Ask for additional information on the whole range of **RuB** valves and consult with your supplier for special applications.

