

s.34 mini

1/8"-1/2"

drawn brass
ball valves



Features and Specifications:

- * **One piece** drawn sand blasted brass body incorporating stem neck which provides excellent guidance of the stem,
- * **Approved by** Danish Board of European Technical Approval for Construction Products (DK), Water Byelaws Scheme (UK),
- * Finest brass according to **EN 12164** specification,
- * Each valve is seal tested for **maximum safety**,
- * Pure **Teflon®** (Dupont registered trademark) self-lubricating seats with flexible-lip design,
- * Dual sealing system allows valve to be operated in either directions making **installation easier**,
- * Chrome plated brass ball for **longer life**,
- * **No metal-to-metal** moving parts,
- * Two Viton O-rings at the stem for **maximum safety**,
- * **No maintenance** ever required,
- * Nylon black **lever or T-handle** removable with valve in service,
- * Lever and T-handle clearly show **ball position**,
- * **ISO 228** parallel threads,
- * **Silicone-free** lubricant,
- * 15 bar (Kg/cm²) non-shock cold working **pressure**,
- * -20°C +90°C **temperature**.

Options:

- * **Male by Female** threads,
- * **NPT taper ANSI B.1.20.1** Female by Female threads,
- * **Yellow** lever or T-handle,
- * **Screw driver or wrench operated**.



NOTE: Approvals apply to specific configurations only.

The product described in this document meets the requirements of PED Directive 97/23 and according to art.3 par.3, it does not require CE marking.

APPROVED BY





RUBINETTERIE UTENSILERIE BONOMI SRL

VIA PADANA SUPERIORE, 27/29 - FRAZ. CILIVERGHE, 25080 MAZZANO (BS) - ITALY

Fax+39 030 2629498
 Phone+39 030 212441
<http://www.rubvalves.com>
 email: sales.director@rubvalves.com

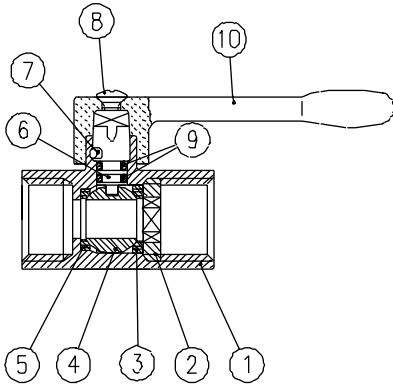

PART DESCRIPTION	Material	Q.ty
1 Chrome plated body	CW614N RUB001	1
2 Retainer nut	CW614N RUB001	1
3 Retainer seat	Ptfe RUB008	1
4 Chrome plated ball	CW614N RUB001	1
5 Body seat	Ptfe RUB008	1
6 Unplated stem	CW614N RUB001	1
7 Pin	AISI430 RUB004	1
8 Chrome plated screw	CW614N RUB001	1
9 Green O-Ring	Viton RUB009	2
10 Black handle	Nylon RUB007	1

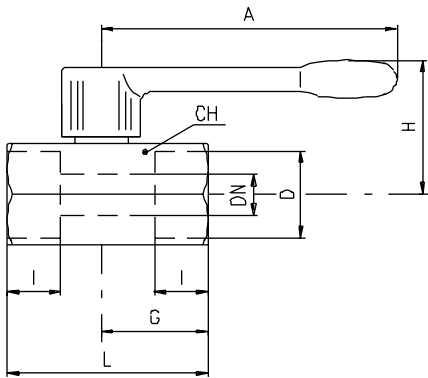

Code	S34AF0	S34BF0	S34CF0	S34DF0
D (inch)	1/8	1/4	3/8	1/2
DN(mm)	6	8	8	10
I (mm)	10	11	11	13
L (mm)	41.5	41.5	41.5	49
G (mm)	22	22	22	26
A (mm)	72	72	72	72
H (mm)	30.5	30.5	30.5	32.5
CH(mm)	21	21	21	25

DN shows the nominal flow diameter. For details on other configurations, ask our Service Center.

Pressure - Temperature chart

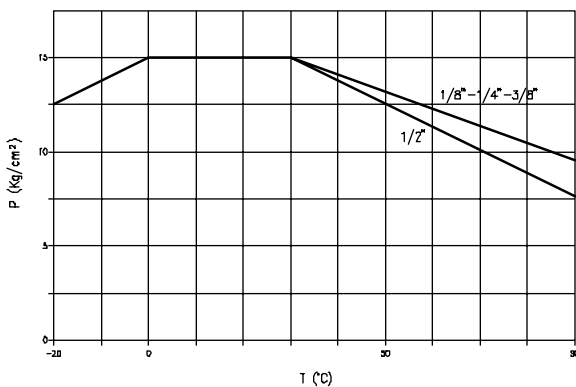

Pressure drop chart

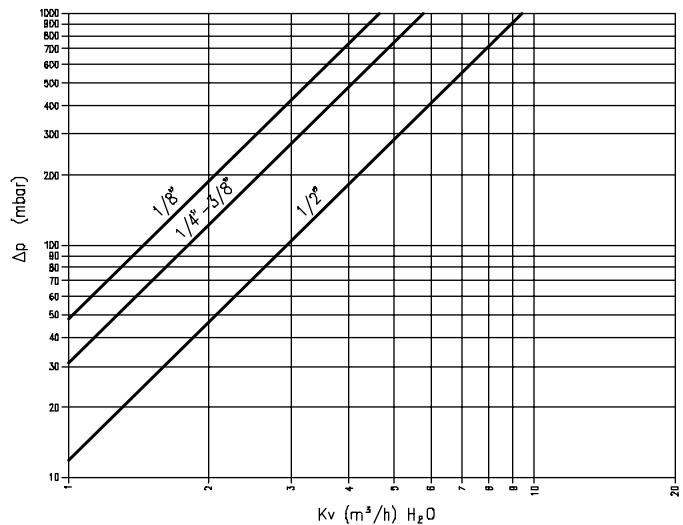

Ask for additional information on the whole range of **RuB** valves
 and consult with your supplier for special applications.



